



Brazoria Drainage District No. 4

4813 W. Broadway
Pearland, TX 77581

Tel: 281-485-1434
Fax: 281-485-0065

Brazoria Drainage District No. 4
Benchmark Sheet

Benchmark No. M-16

General Location: County Road 107 (Arnold Road) at Mary's Creek Prong

Latitude: 29° 32' 05.11" N

Longitude: 95° 20' 35.37" W

Grid Northing: 13,760,153.43

Grid Easting: 3,131,113.25

State Plane Coordinates, Texas South Central Zone
(4204), NAD 83

Elevation: 53.67 NAVD 88, 2001 Adjustment

Benchmark No. M-16 is a brass disk stamped 'Brazoria Drainage District No. 4 BM No. M-16' set on the downstream side of a concrete bridge at County Road 107C (Arnold Road) and Mary's Creek Prong, north side of County Road 107C, in KeyMap page 614W near Unit B100-00-00.

Date: 05/09/13

Detail Sketch

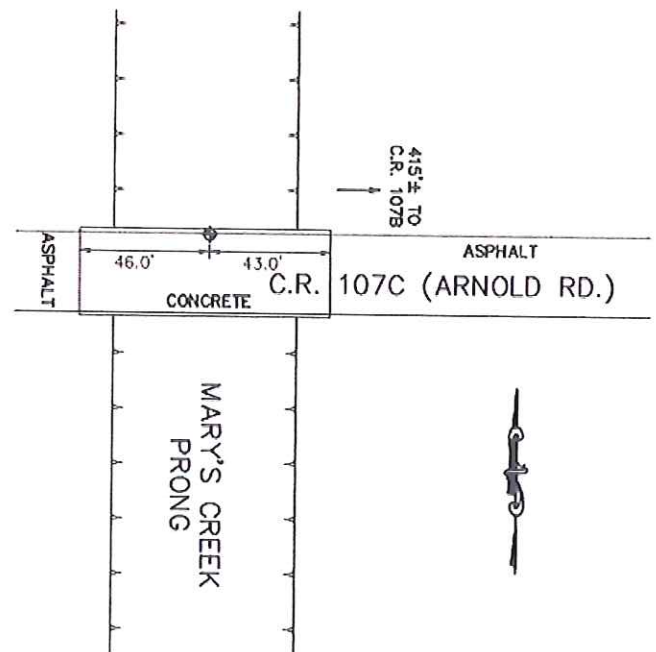

Photo - Station Detail



Photo - Station Area

