



Brazoria Drainage District No. 4

4813 W. Broadway
Pearland, TX 77581

Tel: 281-485-1434
Fax: 281-485-0065

Brazoria Drainage District No. 4
Benchmark Sheet

Benchmark No. CR58-1

General Location: County Road 58 at Outfall "A"

Latitude: 29° 30' 43.40" N

Longitude: 95° 24' 47.71" W

Grid Northing: 13,751,214.47

Grid Easting: 3,109,088.22

State Plane Coordinates, Texas South Central Zone
(4204), NAD 83

Elevation: 59.14 NAVD 88, 2001 Adjustment

Benchmark No. CR58-1 is a brass disk stamped 'CR58-1' set on a concrete headwall at the intersection of Outfall "A" and the north side of County Road 58, in KeyMap 652G near CR58 West Detention.

Date: 09/11/15

Detail Sketch

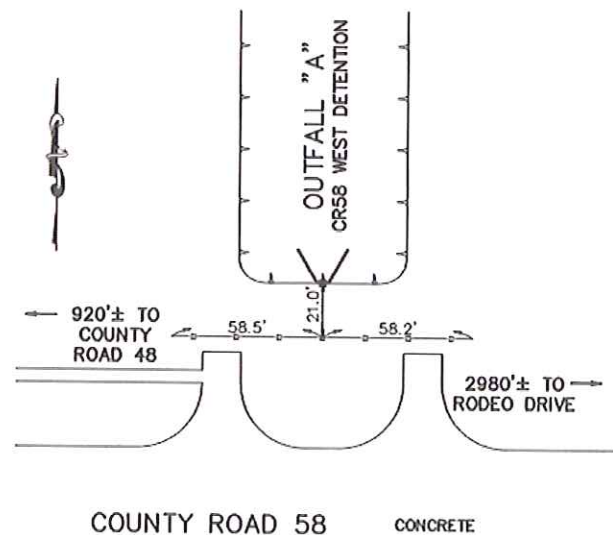

Photo - Station Detail



Photo - Station Area

